

Raven Product Launch 2017

PRODUCT RANGE

Silicon Raindrop Seal

Suitable for weather and energy saving



RP700



Location	Compression	Seal Sizes	Standard Finish
Aluminium, PVC or timber door and window frame where dimensions suit.	4mm to 5mm.	54m reel (3 x 18m).	Brown or black.
Seal Material	Replacement Seal	Approvals	Durability
Silicon Rubber	-	Weather & Energy	



PRODUCT RANGE

Silicon Raindrop Seal

Suitable for weather and energy saving



RP710



Location	Compression	Seal Sizes	Standard Finish
Aluminium, PVC or timber door and window frame where dimensions suit.	3mm to 4mm.	54m reel (3 x 18m).	Brown or black.
Seal Material	Replacement Seal	Approvals	Durability
Silicon Rubber	-	Weather & Energy	

PRODUCT RANGE

Silicon Raindrop Seal

Suitable for weather and energy saving



RP720



Location	Compression	Seal Sizes	Standard Finish
Aluminium, PVC or timber door and window frame where dimensions suit.	2mm to 3mm.	54m reel (3 x 18m).	Brown or black.
Seal Material	Replacement Seal	Approvals	Durability
Silicon Rubber	-	Weather & Energy	



PRODUCT RANGE

Perimeter Seals

Ideal for automatic doors



RP51F



Location	Min/Max Gap	Seal Sizes	Standard Finish
Head and jambs of automatic sliding doors.	Up to 13mm (user determined).	1250, 3000mm.	Aluminium anodised. Satin clear (Silver) finish.

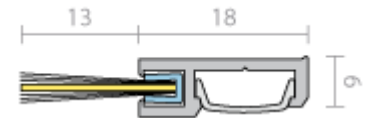

Seal Material	Replacement Seal	Approvals	Durability
Fine dense, black nylon filaments, UV stabilized and medium temperature fin. Galvanised steel spine.	RP52F.	Smoke, Energy	

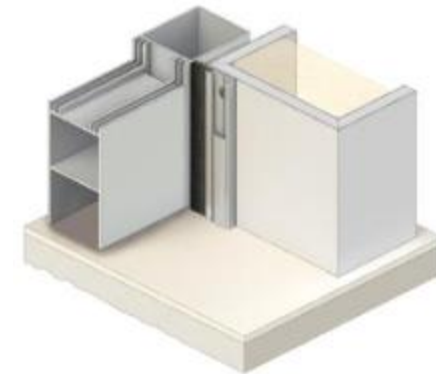

PRODUCT RANGE

Meeting Stile Seals for Frameless Glass

Smoke seal designed for frameless & metal framed glazed stacked sliding doors.



RP43Si



Location	Min/Max Gap	Seal Sizes	Standard Finish
Between panels of frameless & metal framed glazed sliding doors.	30mm to 50mm.	3000mm.	Satin clear (silver) anodised aluminium (15µm).

Seal Material	Replacement Seal	Approvals	Durability
Silicon Rubber	-	Smoke & Energy	

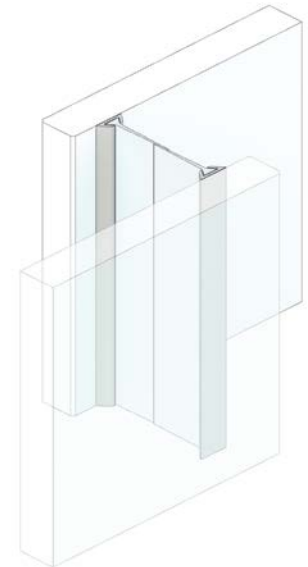

PRODUCT RANGE

Meeting Stile Seals for Frameless Glass

Weather & energy application



RP105



Location	Min/Max Gap	Seal Sizes	Standard Finish
Between panels of frameless & metal framed glazed sliding doors.	15mm to 28mm (prior to installation).	3000mm.	-

Seal Material	Replacement Seal	Approvals	Durability
Clear polymer seal	-	Energy	

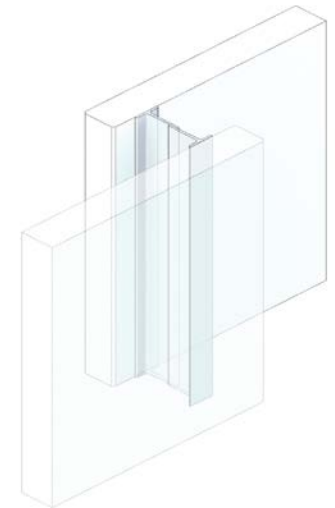
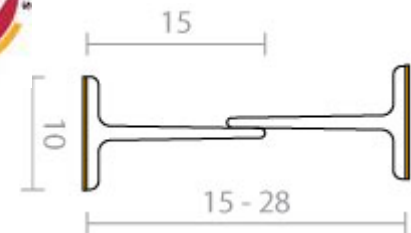

PRODUCT RANGE

Intumescent Fire Seals



RP135Si

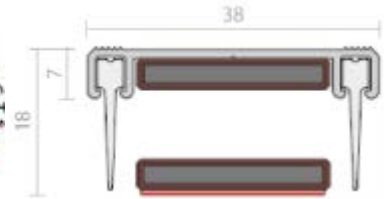

Location	Min/Max Gap	Seal Sizes	Standard Finish
Perimeter of pivot doors.	14mm to 18mm.	Available in stock lengths.	Satin clear (silver) anodised aluminium (15µm).

Seal Material	Replacement Seal	Approvals	Durability
Light grey silicon rubber (SE).	RP3129Si.	Smoke.	-

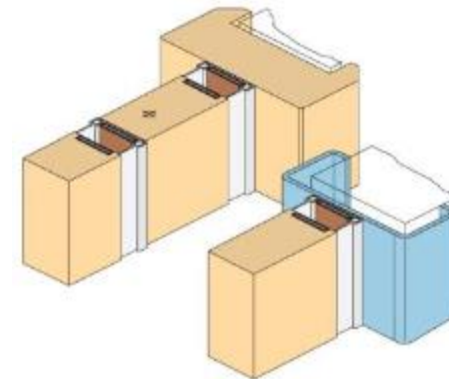

PRODUCT RANGE

Intumescent Fire Seals



RP136F



Location	Min/Max Gap	Seal Sizes	Standard Finish
Door bottom of butt hinged and pivot doors.	15mm to 18mm.	Available in stock lengths.	Satin clear (silver) anodised aluminium (15µm).

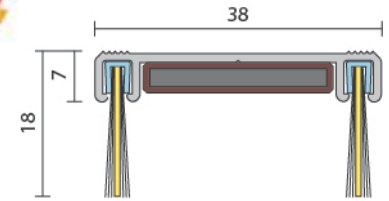

Seal Material	Replacement Seal	Approvals	Durability
Black fine and dense nylon filaments, UV stabilised medium temperature smoke barrier fin and galvanised steel spine.	RP52F.	Smoke.	-

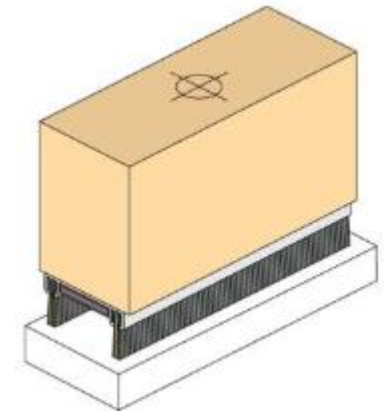

PRODUCT RANGE

Intumescent Fire Seals



RP160



Location	Min/Max Gap	Seal Sizes	Standard Finish
Around rebated frames of single and double butt hinged doors.	2.5mm to 7mm.	Available in stock lengths.	-

Seal Material	Replacement Seal	Approvals	Durability
Black or white co-extruded rigid and flexible fin retardant PVC with intumescent infill.	-	Smoke.	-

